



AVAILABLE FOR LEASE | PHASE 1 BUILDING #5 - 74,482 SQUARE FEET



» BUILDING FEATURES:

- **Clear Height:** 28'
- **Sprinkler System:** ESFR
- **Loading:** 15 Dock High Door Positions
- Dock Packages To Suit
1 Ground Level Door
- **Warehouse Lighting:** To Suit
- **Truck Court:** 185' Clear & Fully Secured
- **Trailer Parking:** 30 Spaces
- **Auto Parking:** 36 Spaces



PHASE 1 CONCEPTUAL ELEVATIONS

» PORT GRANDE FEATURES:

- Up to 2 Million SF+ Buildings
- Expansion Capabilities
- Immediate access to Union Pacific Intermodal
- 10 miles to Commercial Border Crossings
- Fully Gated and Secured Building
- Lot Sales Available
- 1 Acre - 500 Acres Available

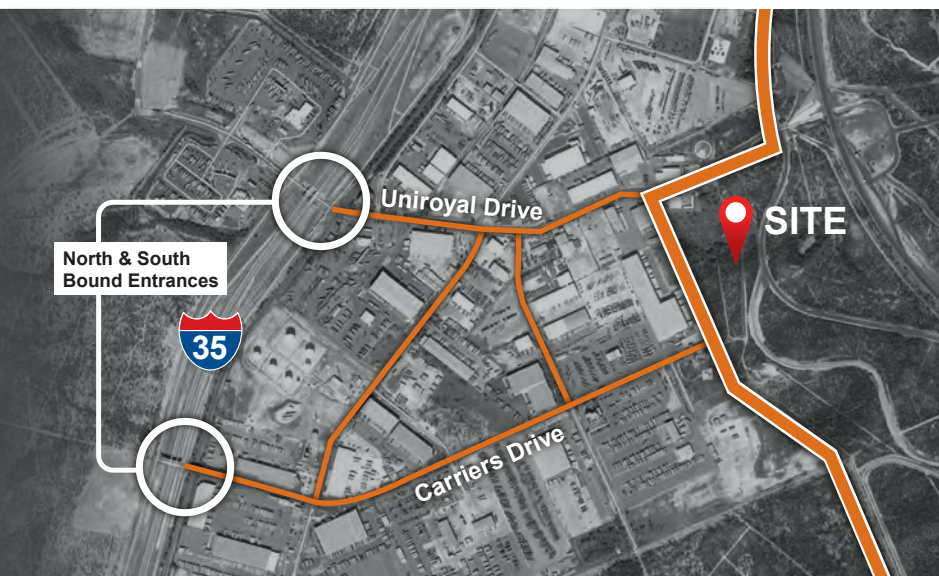

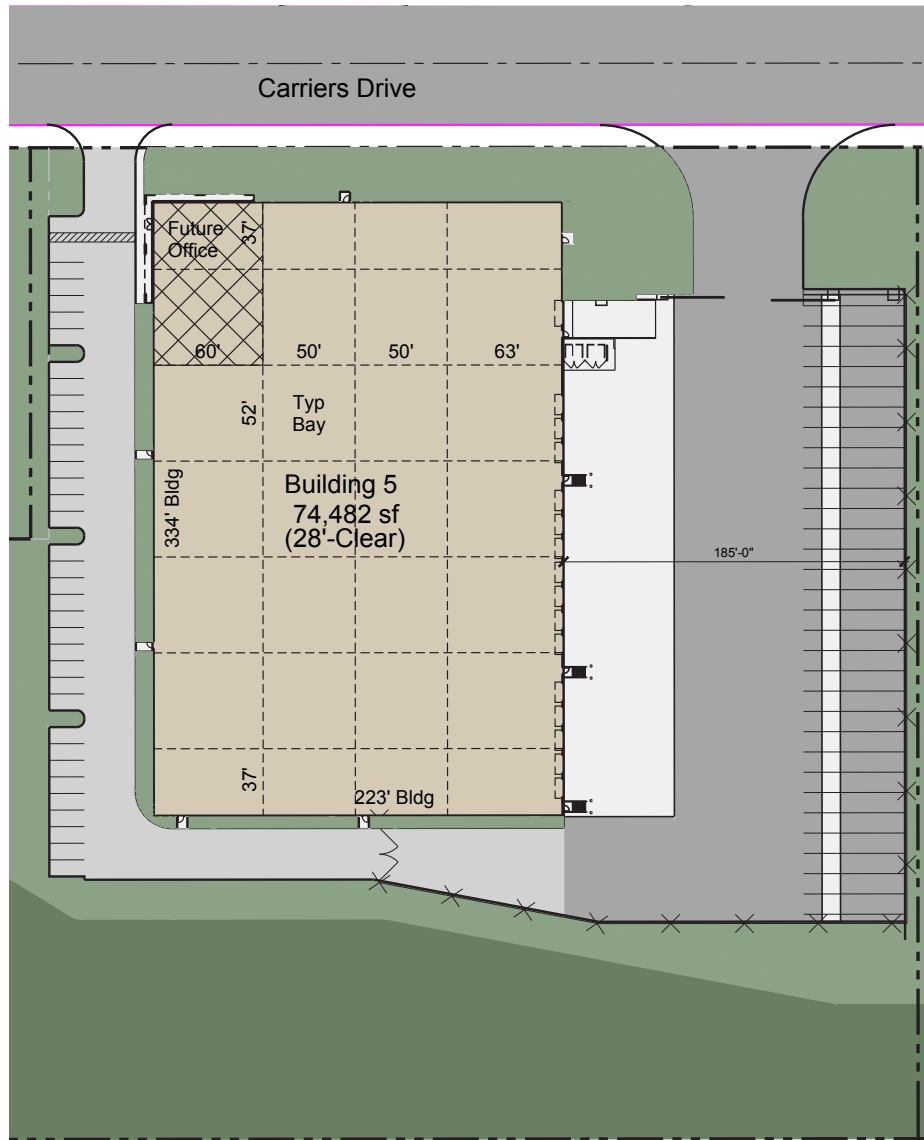

AVAILABLE FOR LEASE | PHASE 1 BUILDING #5 - 74,482 SQUARE FEET

FOR ADDITIONAL INFORMATION:

Kyle Valley - 562.948.4339
kylevalley@majesticrealty.com

Carlo Molano - 956.717.9090
carlom@forumcre.com

Thomas B. Simmons - 562.948.4347
tsimmons@majesticrealty.com



1410 Medical Loop • Suite 1B • Laredo, Texas 78045-9998
Tel: 956.717.9090 • www.forumcre.com

13191 Crossroads Parkway North • Sixth Floor • City of Industry, CA 91746-3497
Tel: 562.692.9581 • Fax: 562.695.2329 • www.MajesticRealty.com

